



Toolless Cat. 6A RJ45 Plug, STP

Part no.: MP0044

Technical Features

Field Assembly Cat. 6A Plug, Shielded

For solid or stand wire 23~26AWG

For cable diameter from 6,0 ~ 9,0mm

Tool-free termination

Including booth, cap & wire guide plate

Technical Drawings

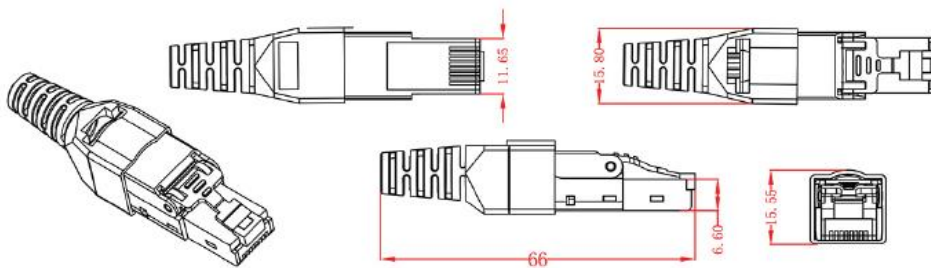

Electrical

1. Contact Resistance: 20m ohms max.
2. Insulation Resistance: 250m ohms min@500DC
3. Withstand Voltage: DC1000V AC700V RMS 60Hz,1MIN
4. CAT6 Permanent Link: Conform to ANST/TIA/EIA 568B.2-10

Environmental

1. Storage: -40°C~+70°C
2. Operation: -10°C~60°C

- ① Remove the Cable tie before installation.

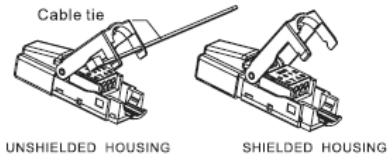

- ② Insert cable into strain relief boot, strip off 1.2 inch of cable jacket, fold back braid and drain wire.

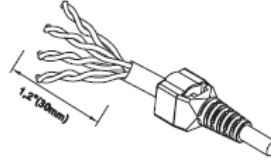

Boot adjustment

Cut the end of boot to fit your cable OD.

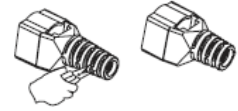

- ③ Fan out all four twisted pairs, following the color coding label and allocate each conductor into proper slots on wiring cap. Trim the ends of conductors.

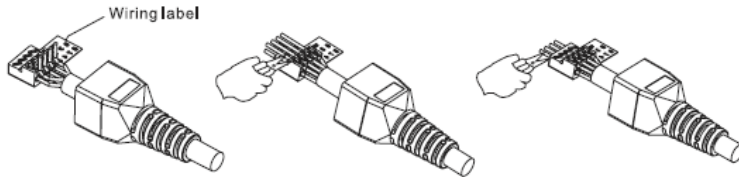

- ④ Place wiring cap on plug.

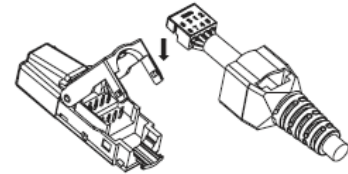

- ⑤ Place the wiring cap onto plug, use plier to clamp wiring cap until it completely snap-in to effect the connection.

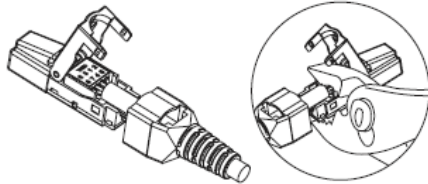

- ⑥ Close plug cover, make sure the drain wire is in proper contact with grounding clip on plug. Pull back strain relief boot to cover the plug, fasten supplied cable tie to secure grounding contact.

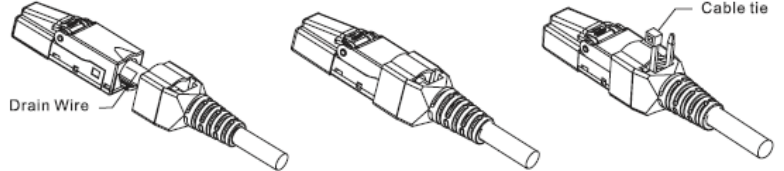

Unload the cable

Cut off cable tie, remove the boot. Using flat screw driver and pry gently on plug cover one end first and the other end subsequently to open it.

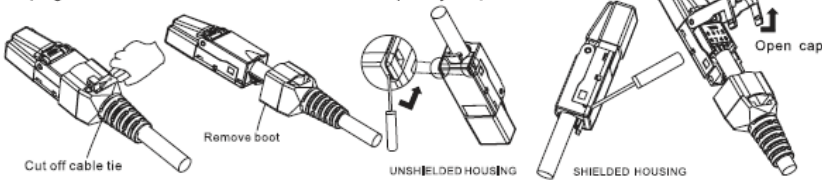

Package Contents

1 x Toolless Cat. 6A RJ45 Plug, STP
1 x User Manual

Packaging Informations

Packing Dimension	mm
Packing Weight	kg
Carton Dimension	mm
Carton Q'ty	pcs
Carton Weight	kg